



THE WORLD'S FINEST DATA CENTERS

This 315,000 square foot mission critical data center is located on the Price Road tech corridor in Chandler, Arizona, just 20 minutes from downtown Phoenix.

The facility is owned and operated by 365 Main Inc., developer and operator of the world's finest data centers. 365 Main's data centers are certified to the highest industry standards and compliance requirements, and feature 24/7/365 power, cooling, connectivity and security capabilities to ensure mission-critical operations and business continuity for tenants.

2121 S. PRICE ROAD
CHANDLER, AZ 85286

FACILITY SIZE

Approximately 314,600 rentable square feet.

COMPLETED

1st Quarter, 2008

RAISED FLOOR AREA

Raised Floor Area is 141,472 Usable Square Feet ("USF").

RAISED FLOOR SYSTEM

24" raised floor manufactured by Tate.

FLOOR LOAD

Typical structural capacity of 200 pounds per square foot on slab.

BUILDING ACCESS

24 hours per day, 7 days per week, 365 days per year.

BUILDING SECURITY

- Security system – State of the art system; 24 hours per day, 7 days per week, 365 days per year operation.
- Video surveillance at all building entrances.
- Perimeter fence near property line provides 50+ yard set-back from property line.
- Shipping and receiving dock with remote monitored gate and secured storage.
- Private parking area for all employees and customers.
- Monitored visitor parking.

TELECOMMUNICATIONS

- Carriers currently installed: AboveNet, AGL Networks, AT&T, Cox Communications, Cogent, InterNap, Level (3) Communications, Qwest and Verizon Business.

COMMERCIAL POWER

- Utility – SRP.
- Most economical power utility in the valley.
- 69kV substation on site delivers power capacity up to 150 W/sf.
- Total power plant 30 MW.

GENERATOR

- Sixteen (16) generators provide back-up power to the facility, four (4) 2MW Caterpillars and twelve (12) 2.25MW Hitec CPS units.
- Entire generator plant designed to minimum N+1 redundancy.

FUEL TANK

- 130,000 gallons, on site.
- Fuel storage for minimum 48-hour run time.

FIRE SUPPRESSION

- VESDA (Very Early Smoke Detection Alarm) above and below floor.
- Double interlock pre-action throughout.

HVAC

- Water cooled chiller plant with 1,800 tons total.
- N+1 redundancy on all systems.
- On-site water treatment system.
- Cooling capacity of raised floor: 8,200 tons.

MAKE-UP WATER

- Back-up water system.
- 60,000 gallon storage tank.

CEILING HEIGHTS

Typically finished 12 feet from raised floor.

COLUMN SPACING

Typically 30 feet center to center.

LOADING AREA

Secure enclosed loading area.

PARKING

106 total parking spaces.

FLOORPLATE

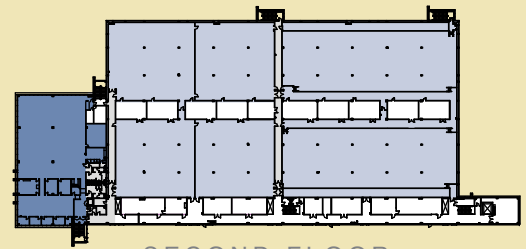

SECOND FLOOR

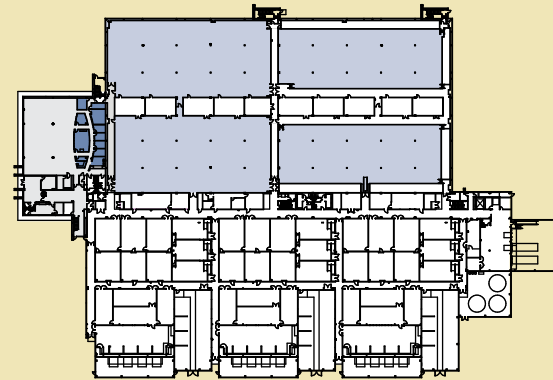

FIRST FLOOR

LEGEND

- Data Room Common
- Data Room
- Office
- Common

