



## THE WORLD'S FINEST DATA CENTERS

This 111,000 square foot mission critical data center is located near Jack London Square in Oakland, California. Built in 2001, the data center is strategically located in the region's fiber-rich district next to a PG&E substation.

The facility is owned and operated by 365 Main Inc., developer and operator of the world's finest data centers. 365 Main's data centers are certified to the highest industry standards and compliance requirements, and feature 24/7/365 power, cooling, connectivity and security capabilities to ensure mission-critical operations and business continuity for tenants.

720 2ND STREET  
OAKLAND, CA 94607

**FACILITY SIZE**

111,183 rentable square feet with approximately 80,000 usable square feet of raised floor.

**COMPLETED**

4th Quarter, 2001.

**RAISED FLOOR AREA**

Raised floor area of 80,000 usable square feet.

**RAISED FLOOR SYSTEM**

30" raised floor manufactured by Tate.

**FLOOR LOAD**

Structural capacity of 150-250 pounds per square foot on slab (central 30% of each floor is 250 lbs/sf).

**BUILDING ACCESS**

24 hours per day, 7 days per week, 365 days per year.

**BUILDING SECURITY**

On-site, staffed security station 24 hours per day, 7 days per week, 365 days per year. Alarm system with security cameras on all perimeter points of ingress/egress to the building with 30 day storage. Secure reception and shipping/receiving areas. Biometric security system in place.

**TELECOMMUNICATIONS**

AboveNet, AT&T, GNI, Internap, IP Networks, Level 3, Paxio, Telekenex, Time Warner, Unwired, Verizon Business and Wiline.

**COMMERCIAL POWER**

- Primary service from PG&E.
- 4kw per rack or 150 watts per square foot of raised floor.
- Planned capacity of 14.5MW for entire facility.

**GENERATORS**

- Numerous HiTec generators feature induction coupling (flywheel) system that stores energy to cover power interruptions or switchover to backup power.
- HiTec CPS systems eliminate the necessity of maintaining conventional static UPS (battery strings) and rectifiers.
- HiTec system feeds redundant switchgear providing power to mission critical loads.

**FIRE SUPPRESSION**

Dry pipe, pre-action system enabled by activation of VESDA (Very Early Smoke Detection Alarm) and/or smoke detectors.

**HVAC**

6 chillers and 6 cooling towers for a maximum of 4,800 tons of cooling capacity.

**CEILING HEIGHTS**

12 feet from raised floor to grid.

**COLUMN SPACING**

28'7" and 26' on center.

**LOADING AREA**

Secure loading dock.

**PARKING**

Available on-site.

**FLOORPLATE**

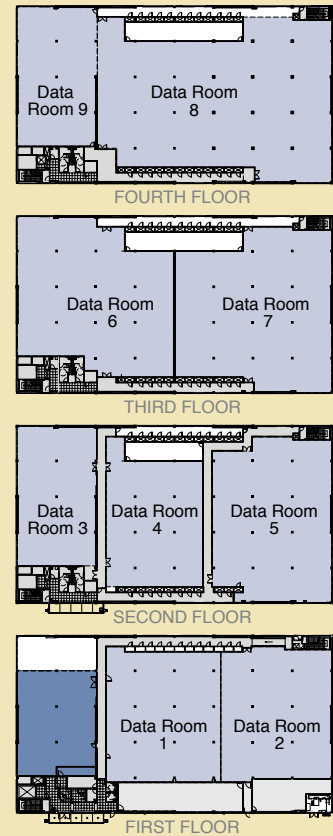

**LEGEND**

- Data Room Common
- Data Room
- Office
- Common

